

Instructions for electrician
STEPS 2 - 9

WARNING:

2

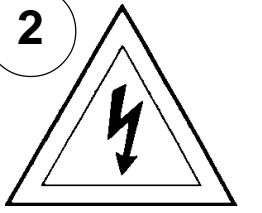

Electrical Danger

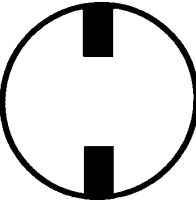

Turn Power Off

All electrical components must be installed by a licensed electrician in accordance with the National Electric Code and the appropriate local electrical codes.

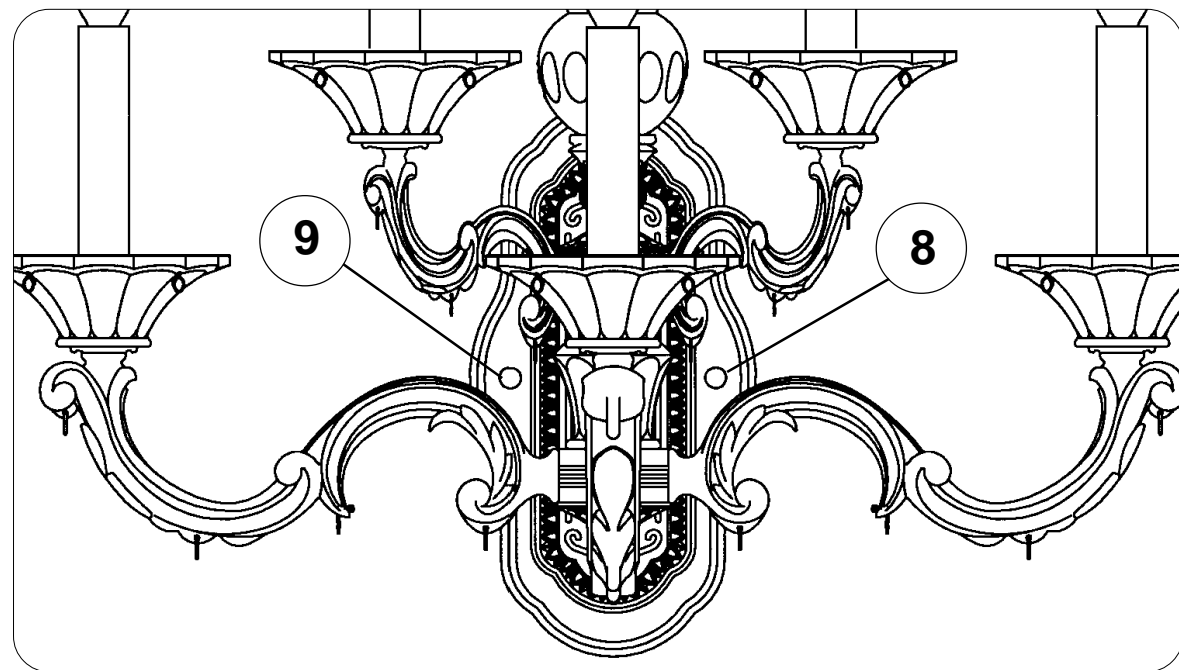
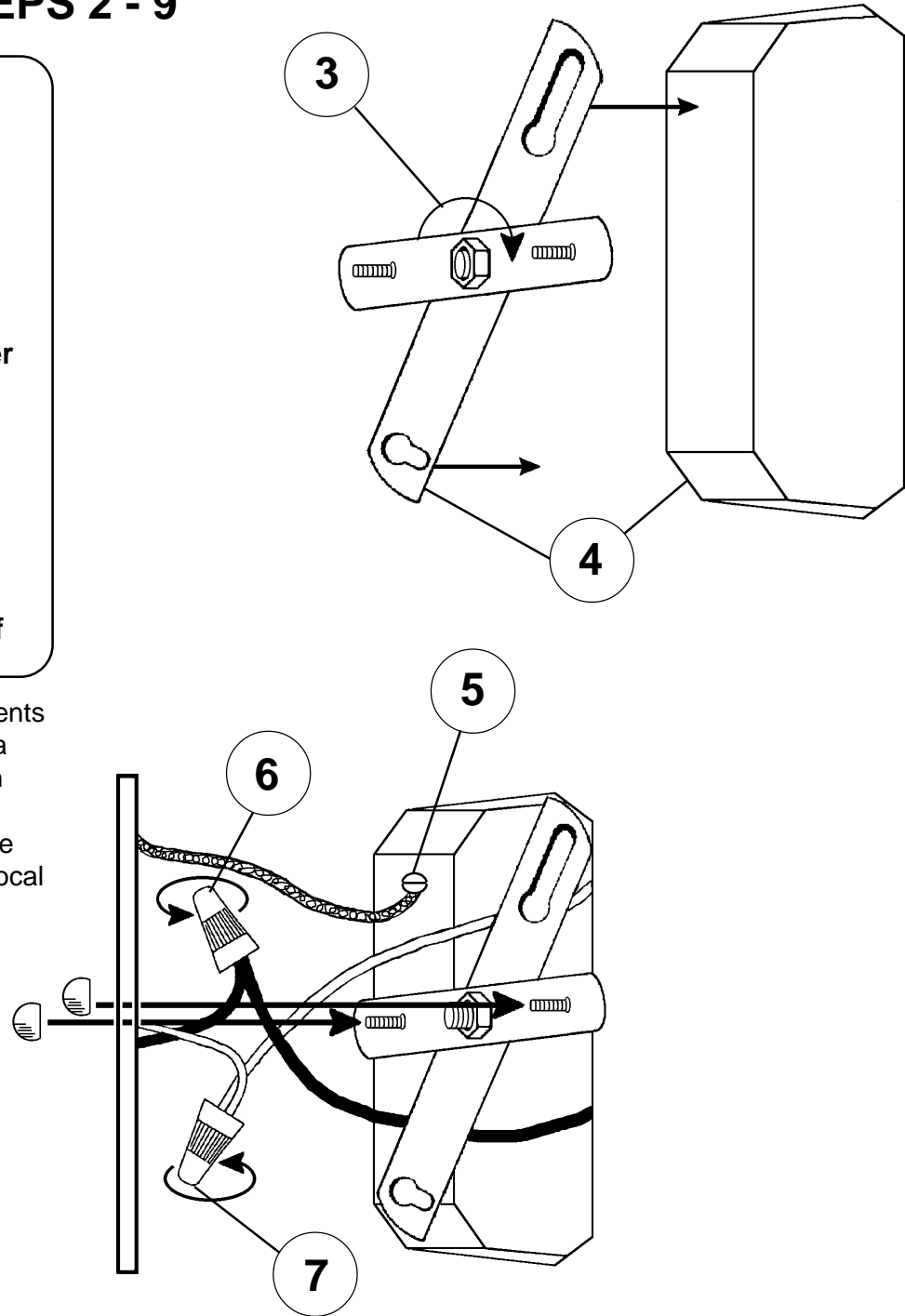

CHANDELIER 5003- ____ TRIM DIAGRAM

(Finish Option)



5 Lights
Diameter: 22"
Body Length: 27"
Extension: 13-1/2"
Hanging Weight: 16 pounds

THIS DESIGN IS THE PROPRIETARY TRADE DRESS/TRADEMARK OF SCHONBEK WORLDWIDE LIGHTING INC.

SCHONBEK®

See diagram on back page
Follow steps in exact order
Save this trim diagram for future reference

1 **IMPORTANT**
Person who opens carton should record the following information for future service.

CODE # _____ Four-digit number on outside of carton.
PACKER # _____ See crystal package label.
ORDER # _____ See crystal package label.



Instructions for crystal trimming

STEPS 10 - 22

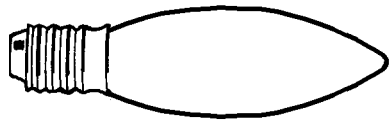

10

You will need 5 - C10
25 Watts Recommended
60 Watts Max

Install bulbs and be
sure to test fixture
BEFORE trimming.



**HANG
CRYSTAL
WITH FLAT
SIDE FACING
FRONT**

VIEW "A"

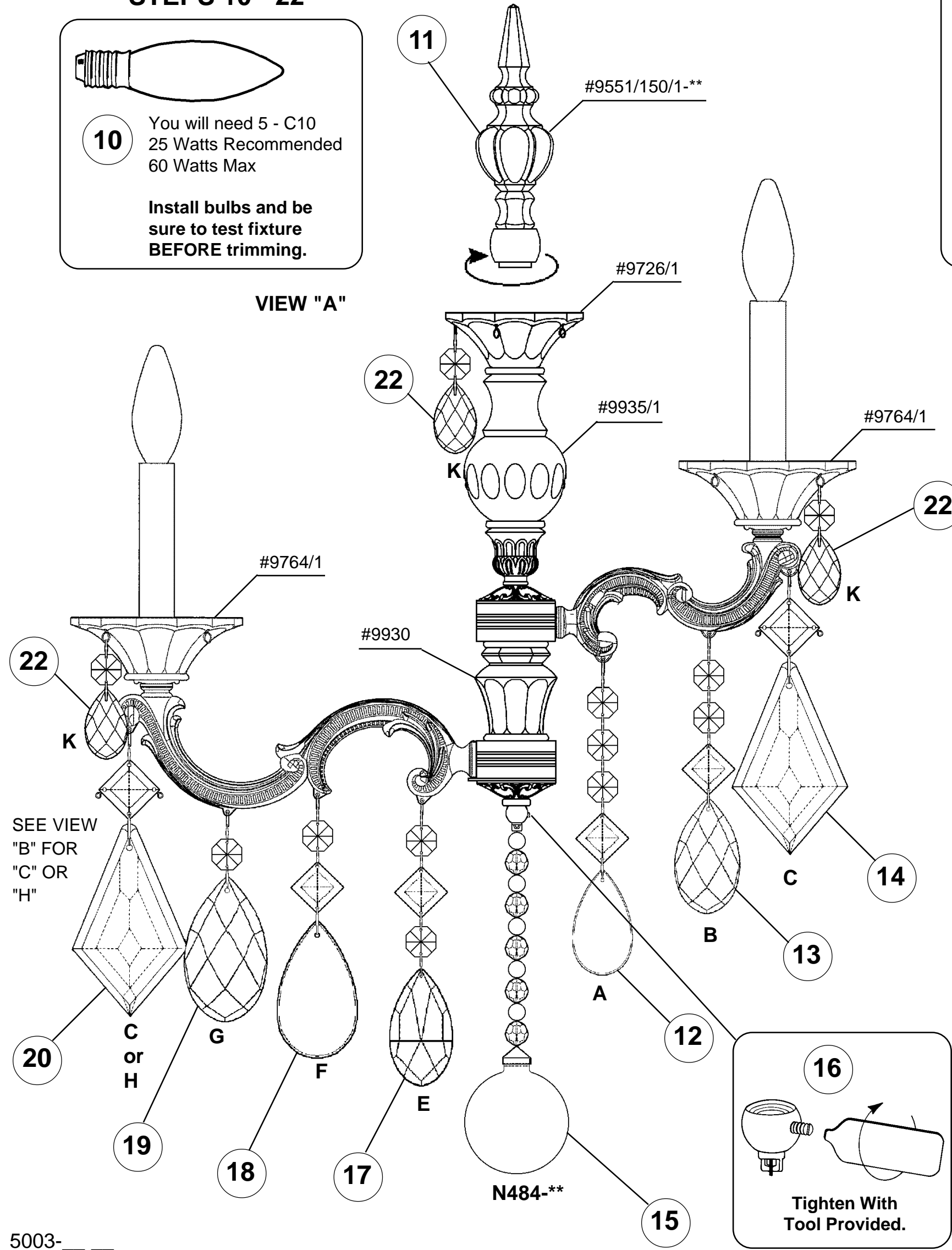

VIEW "B"

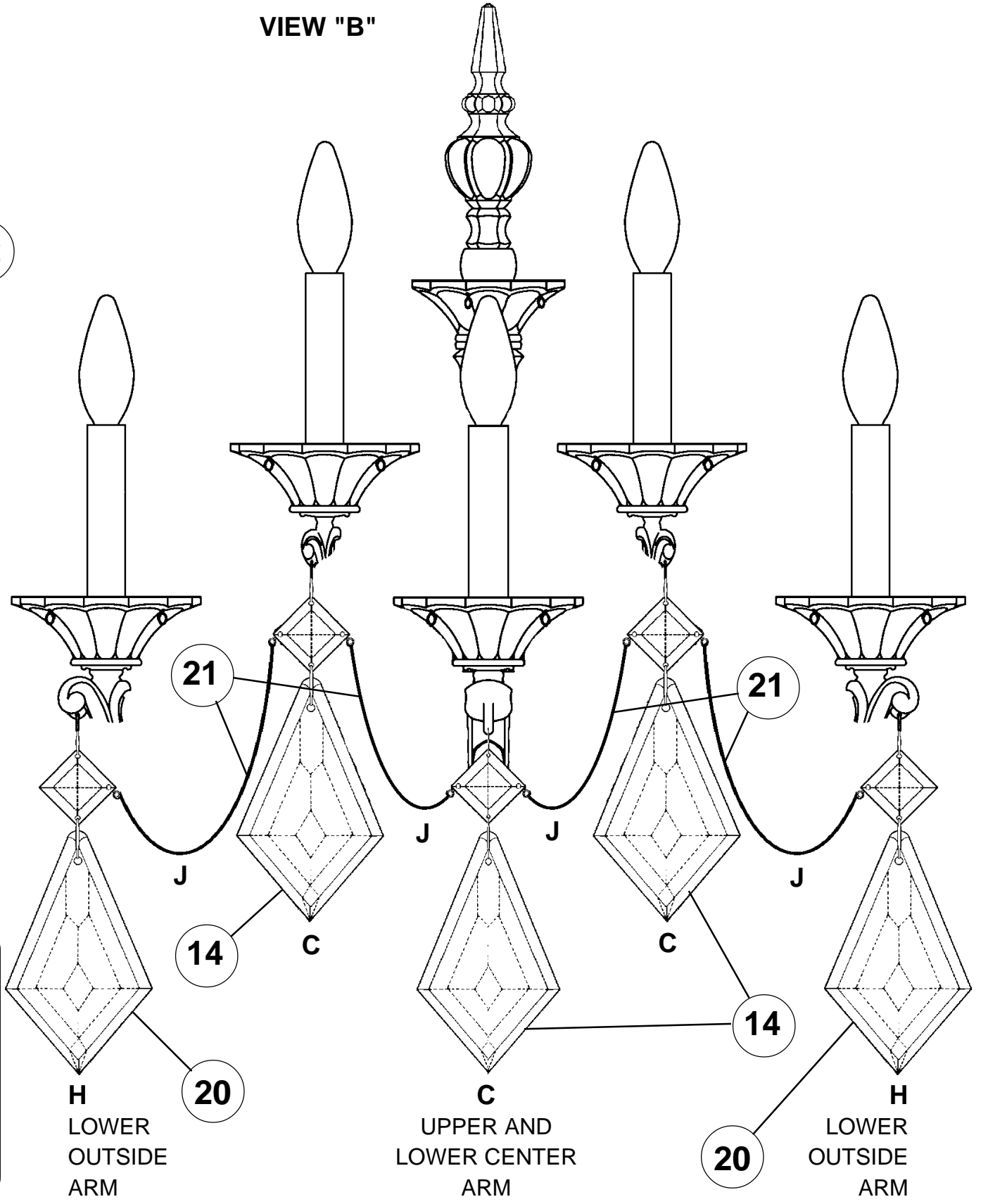

16

**Tighten With
Tool Provided.**